

RECOMMENDED PCB LAYOUT

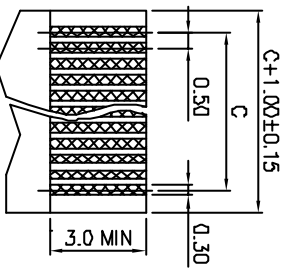
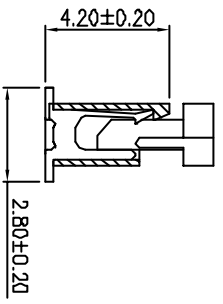

FPC/FFC T = 0.30 ± 0.05

() Mark is major dimension for QC

- MATERIAL
HOUSING: GLASS-REINFORCED THERMOPLASTIC.
CONTACT: COPPER ALLOY.
PLATING: TIN/LEAD PLATED OVER NICKEL
- ELECTRICAL
CURRENT RATING: 0.5 AMP.
DIELECTRIC WITHSTANDING VOLTAGE: 500 VAC MIN.
INSULATION RESISTANCE: 1000M Ω MIN.
CONTACT RESISTANCE: 30m Ω MAX.
- ENVIRONMENTAL
TEMPERATURE RANGE: -40°C TO 105°C.
- DIMENSION TABLE

TOLERANCE		ANGLES		TITLE:	
LINEAR	ANGLES	LINEAR	ANGLES	PART NO.	FPC PITCH D.5 LOCK SMT11BD
X ± 0.2D	X ±	X ± 0.1D	X ±	GFP-19122X-3XX3X1	GFP-19105001
.X ± 0.05	.X ±	.XX ±	.XX ±	CHKD:	UNITS
.XXX ± 0.02	.XXX ±	APPD:	MAT'L:	DRWN: Willson	SCALE
		CHKD:	FINISH:	Q'TY:	SHEET
		DRWN:			1 OF 1
					REV
					0

啟寶興業股份有限公司
KEMAX KE MAX SHING CO., LTD.

